



Concept 2

FP - Front Patio Door
or
FW - Front Window

T.V., Video and all ornaments are for display only.



Model illustrated is the Concept2 'FP' configuration 39/2 bedroom. Decking is for display only.



www.atlas-caravans.co.uk

Concept 2

FP - Front Patio Door
or
FW - Front Window



Features

- Asymmetric pitched roof
- Open vaulted ceiling
- Plastisol coated steel pantile roof
- Double glazed PVCu patio sliding door
- Double glazed PVCu exterior door and windows, featuring night ventilation position
- Domestic style central heating system including combi boiler
- Contemporary radiators to lounge area and kitchen
- Under floor insulation
- Extra Warm Package; thicker walls, extra insulation
- Lagged water pipes
- Galvanised chassis with twin axle
- Domestic quality three piece suite with foldout sprung double bed
- Underlay fitted beneath all carpets
- Woodgrain effect, flush internal doors
- High quality cabinetwork with decorative glass panels
- Stylish flame-effect electric fire in attractive, contemporary surround
- Wooden blinds to lounge area, kitchen, bathroom and main bedroom
- Skylights with integral blinds to dining area and bathroom
- Glass panelled balustrade enclosing raised dining area
- Framed pictures to lounge, hallway and main bedroom
- Coordinating scatter cushions
- Satin-nickel curtain poles with ceramic finials to lounge area
- Fully-lined curtains with coordinating voiles to lounge area and bedrooms
- TV. point
- Freestanding dining table and upholstered chairs
- 700 wide, stainless steel oven with grill and electronic ignition
- 5 ring hob with electronic ignition
- Stainless steel recirculating fan above hob
- 18/8 quality, polished stainless steel, corner double sink
- Integrated side-by-side fridge and freezer
- Microwave oven
- Deluxe metal drawer system
- Ample storage space for household items
- Integrated T.V. unit to main bedroom
- Coordinating bed covers and pillowcases
- Interior sprung mattresses
- Metal, freestanding sprung beds to main and twin bedroom
- Twin beds combine to make a double bed if required
- Under-bed storage in all bedrooms
- High quality ceramic toilet suite
- Domestic size bath with shower and fold away shower screen
- Second shower room
- Thermostatic shower mixer to bath/showers
- Contemporary bathroom fittings
- Coordinating doormat
- Exterior light
- Colour coordinated downpipes
- Retractable tow bar
- Aluminium cladding
- Smoke alarm
- Fire extinguisher

Layout - 12 Wide

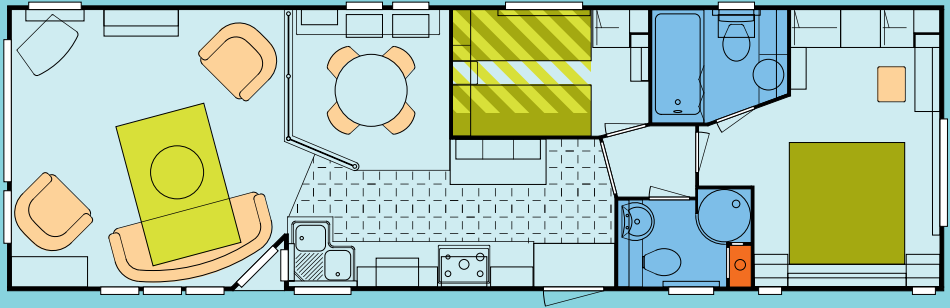

39/2 Bedroom
Body Length - 12.37m (40'-7")
Body Width - 3.79m (12'-5")

6 Berth

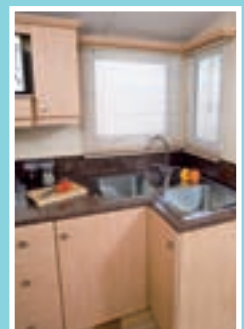
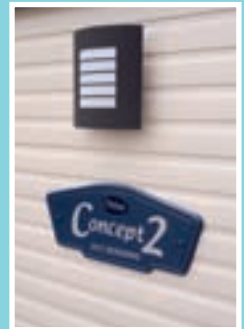

Options for:

- Double glazed PVCu front windows in place of patio sliding door
- Domestic quality three piece leather suite
- Washing machine or dishwasher

Atlas reserves the right to change any materials, fittings etc., shown in this brochure at any time and without prior notice as supply or product development demand. All Atlas Caravan Holiday Homes are built to comply with all relevant British Standards and Codes of Practice as required by the National Caravan Council certification scheme. NOTE: Caravan Holiday Homes are not designed for residential occupancy. "To use an Atlas Caravan Holiday Home, it will need to be correctly sited, have steps or other means of entry and be connected to services (an appropriate propane gas supply, mains electricity to suit the required power offtake, mains water at a pressure to suit the appliances and a waste water/sewage outlet)". Due to the nature of our construction methods and practices, it may not always be possible to match patterns precisely on some wallboards and fabrics. Any Park Operator, anywhere in the UK, can purchase an Atlas Holiday Home for you through the Atlas Dealer/Park Distribution network.



Atlas Caravan Company Ltd.

Wiltshire Road, Hull HU4 6PD.

Telephone No. 01482 562101. Fax No. 01482 566033.

www.atlas-caravans.co.uk



National Inspection Council for
Electrical Installation Contracting
NICEIC
APPROVED CONTRACTOR