



Oakwood Super



T.V., Video and all ornaments are for display only.



Model illustrated is the Oakwood Super 39/2 bedroom.



www.atlas-caravans.co.uk

Oakwood Super



Features

- Pitched roof
- Open vaulted ceiling
- Plastisol coated steel pantile roof
- Double glazed PVCu exterior door and windows, featuring night ventilation position
- Domestic style central heating system including combi boiler
- Under floor insulation
- Extra Warm Package; thicker walls, extra insulation
- Lagged water pipes
- Galvanised chassis with twin axle
- High quality lounge seating with foldout sprung double bed
- Coordinating scatter cushions
- Underlay fitted beneath all carpets
- Woodgrain effect, flush internal doors
- Contemporary cabinetwork with smoked glass panels
- Modern electric fire
- Fully lined curtains to lounge area
- Voiles to lounge area and net curtains to bedrooms (layout dependent)
- Satin nickel curtain poles with ceramic finials to lounge area
- T.V. point
- Freestanding dining table and upholstered chairs in conservatory-style setting
- Wooden blinds to dining area, kitchen and bathrooms
- Breakfast bar with stools
- Stainless steel hob with electronic ignition and high level oven with grill
- Contemporary glass and stainless steel, recirculating extractor fan above hob
- 18/8 quality, linen finish, domestic size, stainless steel sink with drainer
- Integrated fridge and freezer
- Deluxe metal drawer system
- Ample storage space for household items
- Integrated T.V. unit to main bedroom
- Fully lined curtains with swags and tails to bedrooms
- Divan style sprung bed to main bedroom
- Luxury coordinating bedspread, pillows and cushions to main bedroom (39/2 only)
- Shaver socket
- Interior sprung mattresses
- Coordinating bed covers and pillowcases to twin bedrooms
- Metal freestanding sprung beds to twin bedrooms
- Twin beds combine to make a double bed if required
- Under-bed storage in twin bedrooms
- High quality ceramic toilet suite
- En suite bath/shower room
- Domestic size bath with shower and foldaway shower screen (39/2 only)
- Second shower room
- Thermostatic shower mixer to bath/showers
- Stylish bathroom fittings
- Coordinating doormat
- Exterior light
- Colour coordinated downpipes
- Retractable tow bar
- Aluminium cladding
- Smoke alarm
- Fire extinguisher

Layouts - 12 Wide

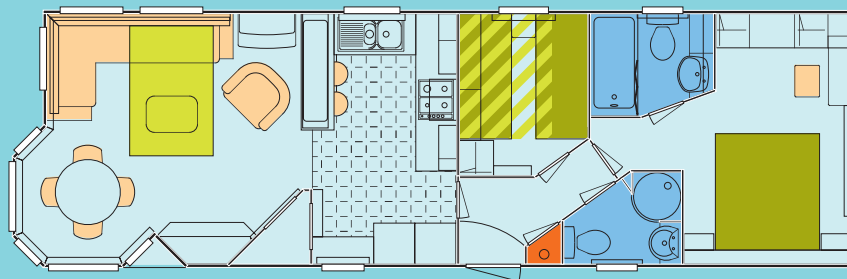

39/2 Bedroom
Body Length (inc. bay) - 12.32m (40'-5 1/4")
Body Width - 3.79m (12'-5")

6 Berth

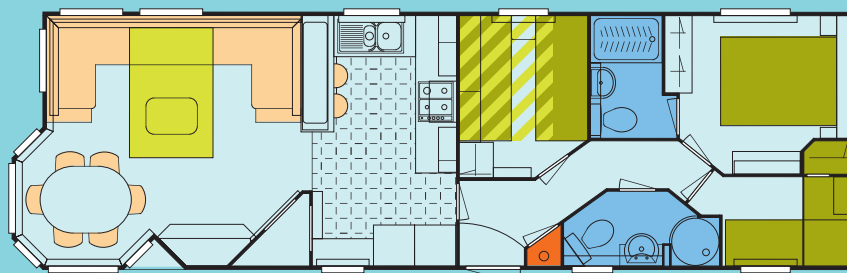

39/3 Bedroom
Body Length (inc. bay) - 12.32m (40'-5 1/4")
Body Width - 3.79m (12'-5")

8 Berth



Atlas reserves the right to change any materials, fittings etc., shown in this brochure at any time and without prior notice as supply or product development demand. All Atlas Caravan Holiday Homes are built to comply with all relevant British Standards and Codes of Practice as required by the National Caravan Council certification scheme. NOTE: Caravan Holiday Homes are not designed for residential occupancy. "To use an Atlas Caravan Holiday Home, it will need to be correctly sited, have steps or other means of entry and be connected to services (an appropriate propane gas supply, mains electricity to suit the required power offtake, mains water at a pressure to suit the appliances and a waste water/sewage outlet)". Due to the nature of our construction methods and practices, it may not always be possible to match patterns precisely on some wallboards and fabrics. Any Park Operator, anywhere in the UK, can purchase an Atlas Holiday Home for you through the Atlas Dealer/Park Distribution network.

Atlas Caravan Company Ltd.

Wiltshire Road, Hull HU4 6PD.

Telephone No. 01482 562101. Fax No. 01482 566033.

www.atlas-caravans.co.uk



APPROVED CONTRACTOR