



Microwave is an optional extra.



Solitaire Super

FD - Front French Doors
or
FW - Front Windows

T.V., Video and all ornaments are for display only.



Model illustrated is the Solitaire Super 38/2 bedroom with front french doors.



www.atlas-caravans.co.uk

Solitaire Super

FD - Front French Doors
or
FW - Front Windows



Features

- Pitched roof
- Open vaulted ceiling
- Plastisol coated steel pantile roof
- Double glazed PVCu exterior door and windows, featuring night ventilation position
- Domestic style central heating system including combi boiler
- Under floor insulation
- Extra insulation
- Lagged water pipes
- Pre-galvanised chassis
- Underlay fitted beneath all carpets
- Domestic quality three piece suite with foldout sprung double bed
- Coordinating scatter cushions
- Embossed six panel, woodgrain effect, flush internal doors
- Modern quality cabinet work with textured glazed panels
- Stylish electric fire with contemporary surround
- Framed pictures to lounge and main bedrooms
- Fully lined curtains to lounge, entrance door and bedrooms
- Voiles to lounge area and net curtains to bedrooms
- T.V. turntable
- T.V. point
- Freestanding glass panelled dining table and upholstered chairs
- Venetian blind to kitchen and bathroom
- Quality stainless steel hob and high level oven with grill
- Stainless steel recirculating cooker hood
- 18/8 quality, double radius, linen finish, stainless steel sink
- Integrated fridge and freezer
- Chrome wire storage basket and wine rack to kitchen
- Deluxe metal drawer system
- Ample storage space for household items
- Shaver socket
- Coordinating bed covers and pillowcases
- Interior sprung mattresses with damask ticking
- Metal freestanding sprung beds to main and twin bedrooms
- Twin beds combine to make a double bed if required
- Under bed storage in all bedrooms
- High quality ceramic toilet suite
- Stylish bathroom fittings
- Tub style bath with shower, sliding glazed door and thermostatic shower mixer
- Coordinating doormat
- Exterior light
- Colour coordinated downpipes
- Retractable tow bar
- Aluminium cladding
- Smoke alarm

Layouts - 12 Wide

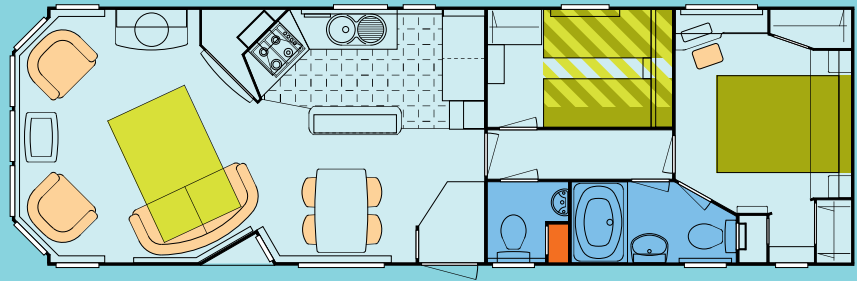

38/2 Bedroom
Body Length (inc. bay) - 11.95m (39'-2 1/2")
Body Width - 3.69m (12'-1")

6 Berth

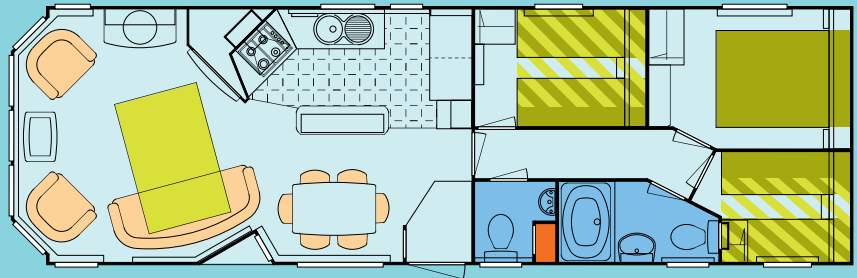

38/3 Bedroom
Body Length (inc. bay) - 11.95m (39'-2 1/2")
Body Width - 3.69m (12'-1")

8 Berth

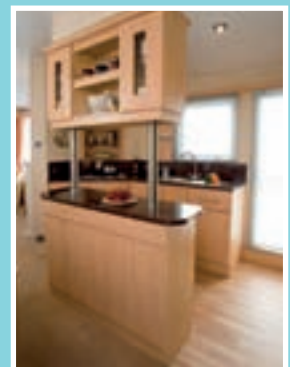
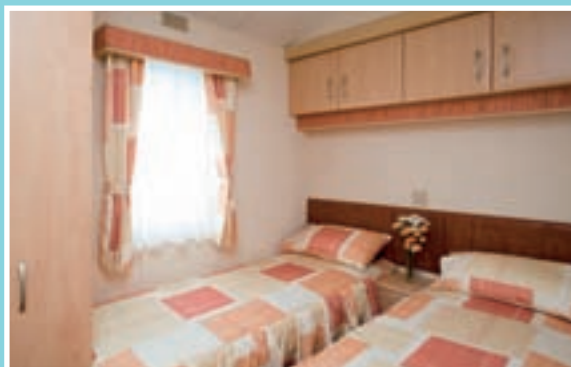

Options for:

- Double glazed PVCu front French doors

Atlas reserves the right to change any materials, fittings etc., shown in this brochure at any time and without prior notice as supply or product development demand. All Atlas Caravan Holiday Homes are built to comply with all relevant British Standards and Codes of Practice as required by the National Caravan Council certification scheme. NOTE: Caravan Holiday Homes are not designed for residential occupancy. "To use an Atlas Caravan Holiday Home, it will need to be correctly sited, have steps or other means of entry and be connected to services (an appropriate propane gas supply, mains electricity to suit the required power offtake, mains water at a pressure to suit the appliances and a waste water/sewage outlet)". Due to the nature of our construction methods and practices, it may not always be possible to match patterns precisely on some wallboards and fabrics. Any Park Operator, anywhere in the UK, can purchase an Atlas Holiday Home for you through the Atlas Dealer/Park Distribution network.



Atlas Caravan Company Ltd.

Wiltshire Road, Hull HU4 6PD.

Telephone No. 01482 562101. Fax No. 01482 566033.

www.atlas-caravans.co.uk

